

# Clutch Rebuilt Kit



Cover Bushing



Sheave Bushing

**Tools shown in instructions are not included**

### Liability Statement

SuperATV's® products are designed to best fit user's ATV/UTV under stock conditions. Adding, modifying, or fabricating any factory or aftermarket parts will void any warranty provided by SuperATV® and is not recommended. SuperATV's® products could interfere with other aftermarket accessories. If user has aftermarket products on machine, contact SuperATV® to verify that they will work together.

Although SuperATV® has thousands of satisfied customers, user should be aware that installing lift kits, long travel, or suspension kits, tires, etc. will change the ride of machine and may increase maintenance and part wear. Operating any off-road machine while, or after, consuming alcohol and/or drugs increases risk of bodily harm or death. No warranty or representation is made as to this product's ability to protect user from severe injury or death. SuperATV® urges operators and occupants to wear a helmet and appropriate riding gear at all times.

By purchasing and installing SuperATV® products, user agrees that should damages occur, SuperATV® will not be held responsible for loss of time, use, labor fees, replacement parts, or freight charges. SuperATV®, nor any 3rd party, will not be held responsible for any direct, indirect, incidental, special, or consequential damages that result from any product purchased from SuperATV®. The total liability of seller to user for all damages, losses, and causes of action, if any, shall not exceed the total purchase price paid for the product that gave rise to the claim.

SuperATV® will warranty only parts provided by SuperATV®. Any damage or problems with OEM housings, bearings, seals, or other manufacturers' products will not be covered by SuperATV®. SuperATV® parts and products are not warranted if item was not installed properly, misused, or modified.

Installing, adding, modifying, or fabricating any factory or aftermarket product to your ATV/UTV may violate certain local, state, and federal laws. Be advised that laws vary depending on town, city, county, state, etc. Use of certain products on public streets, roads, or highways may be in violation law. The Buyer is solely and exclusively legally and personally responsible for any violation of the law by the installation or use of the product. You must abide by all local, state, and federal laws, including but not limited to vehicle safety, traffic laws, and ordinances. It is your responsibility to know the laws and how they apply to you.

The Buyer is responsible to fully understand the capability and limitations of his/her vehicle according to manufacturer specifications, warnings and instructions and agrees to hold SuperATV® harmless from any damage resulting from failure to adhere to such specifications, warnings and/ or instructions. The Buyer is also responsible to obey all applicable federal, state, and local laws and ordinances when operating his/her vehicle while using this product, and the Buyer agrees to hold SuperATV® harmless from any violation thereof.

### Need help with your installation?



sales@superatv.com



www.superatv.com



1-855-743-3427



8:00am - 8:00pm EST M-Th  
8:00am - 7:00pm EST Friday  
9:00am - 2:00pm EST Saturday

**Read instructions and view illustrations before beginning.**

*Thank You*

*For Choosing*

# SUPERATV.COM

- Place Clutch onto Clutch Compression Tool.
- Use a permanent marker and mark Cover, Spider, and both sheaves as shown.



**Marks to be inline when reassembling**

- Compress Clutch and remove screws from Cover.



**Torque screws to 90 in/lbs when reinstalling**

- Remove Cover and Spring.





- Install Clutch onto Clutch Holder.
- Install Spider Nut Tool to Spider Nut.

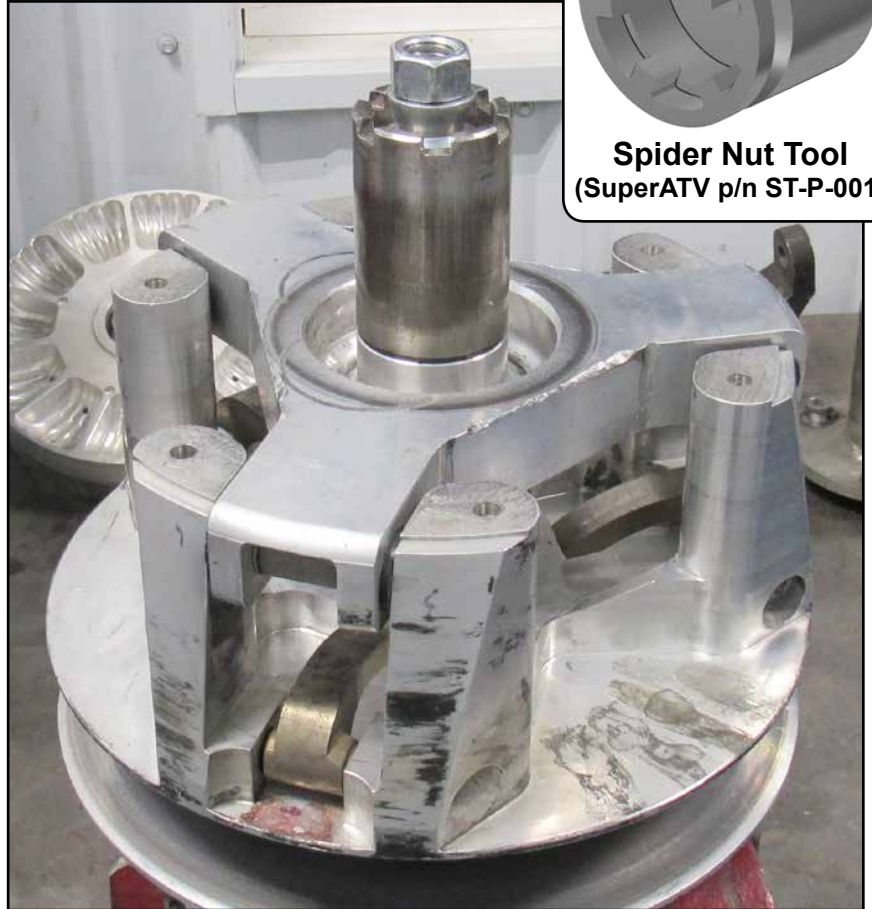

- Remove Spider Nut and Washer.

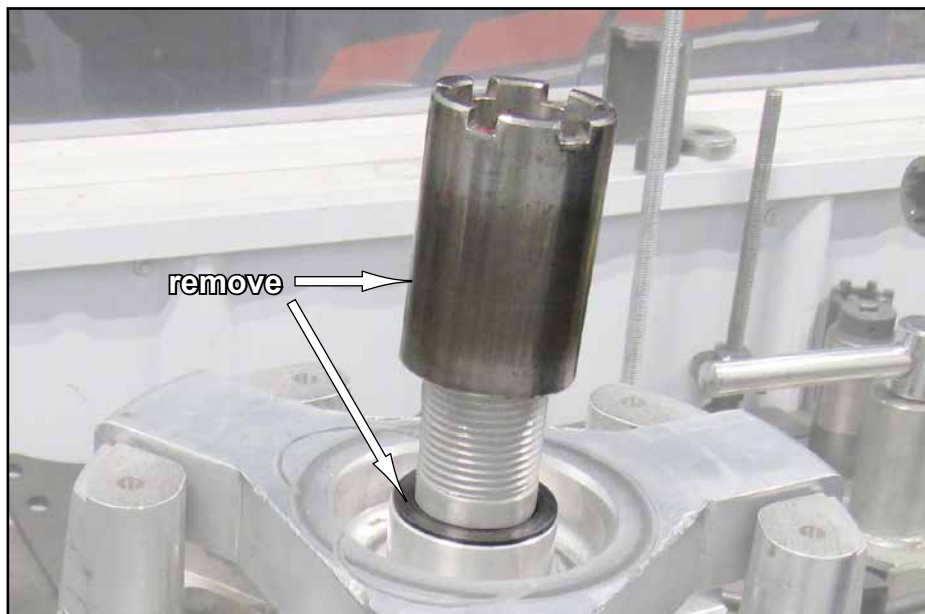

**Torque Spider and nut to 220 ft/lbs when reinstalling**

- Install Spider Removal Tool and remove.



- Place Moveable Sheave/Spider assembly and Stationary Sheave onto workbench.



- Lift Moveable Sheave up and off Spider.



- Remove Buttons and O-Rings from Spider.

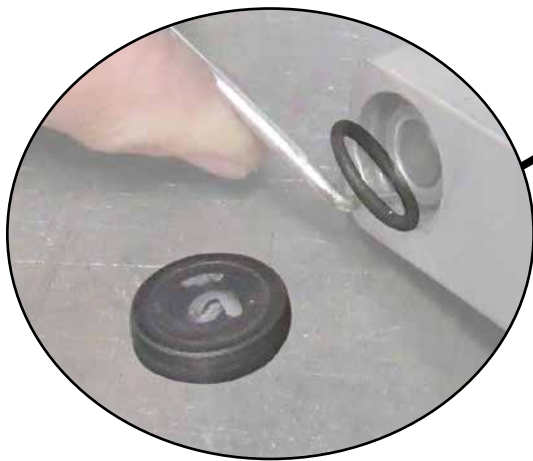

- Press Roller Pins from Spider and remove Washers and Rollers.



- Install new Roller Pins, Rollers, and Washers.

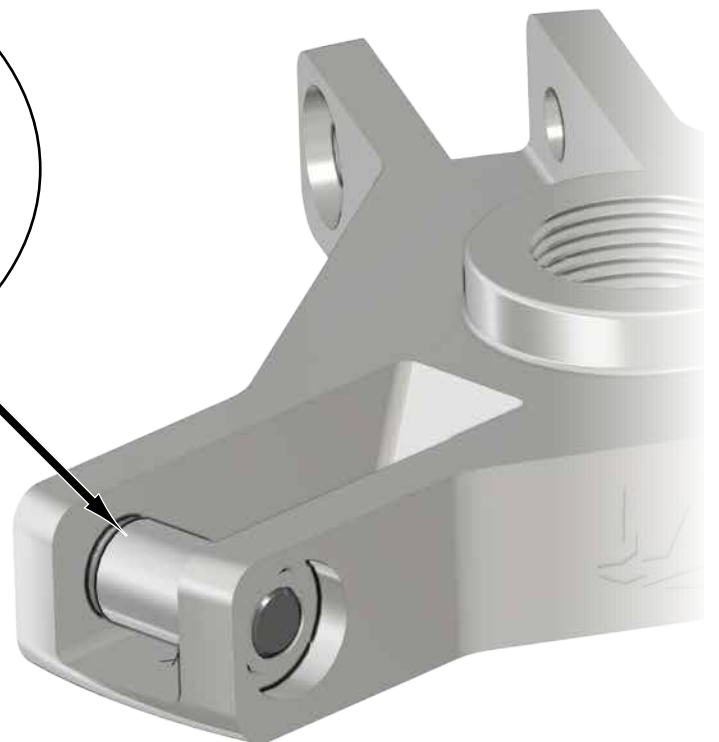
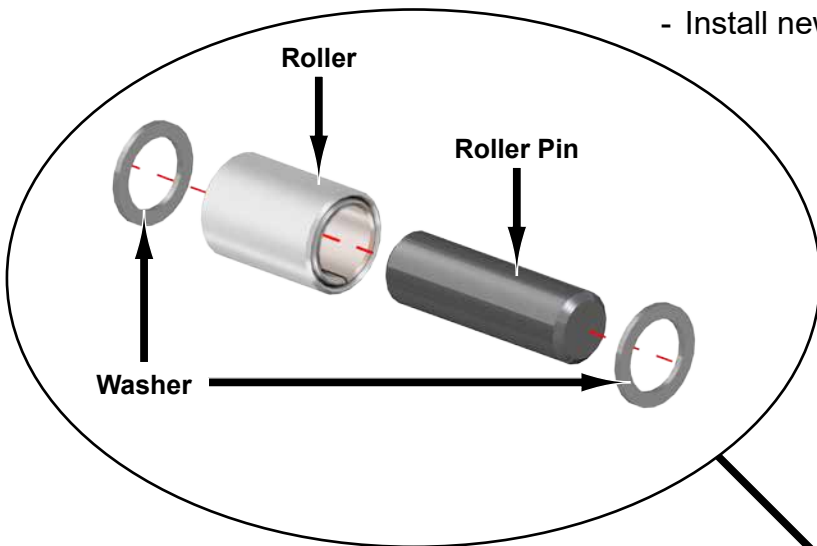

- Remove Snap Ring from Moveable Sheave.



- Place Sheave Tool into Moveable Sheave and press out Bushing.



- Flip Moveable Sheave, install new Bushing, and place Sheave Tool as shown.
- Press Bushing into place.

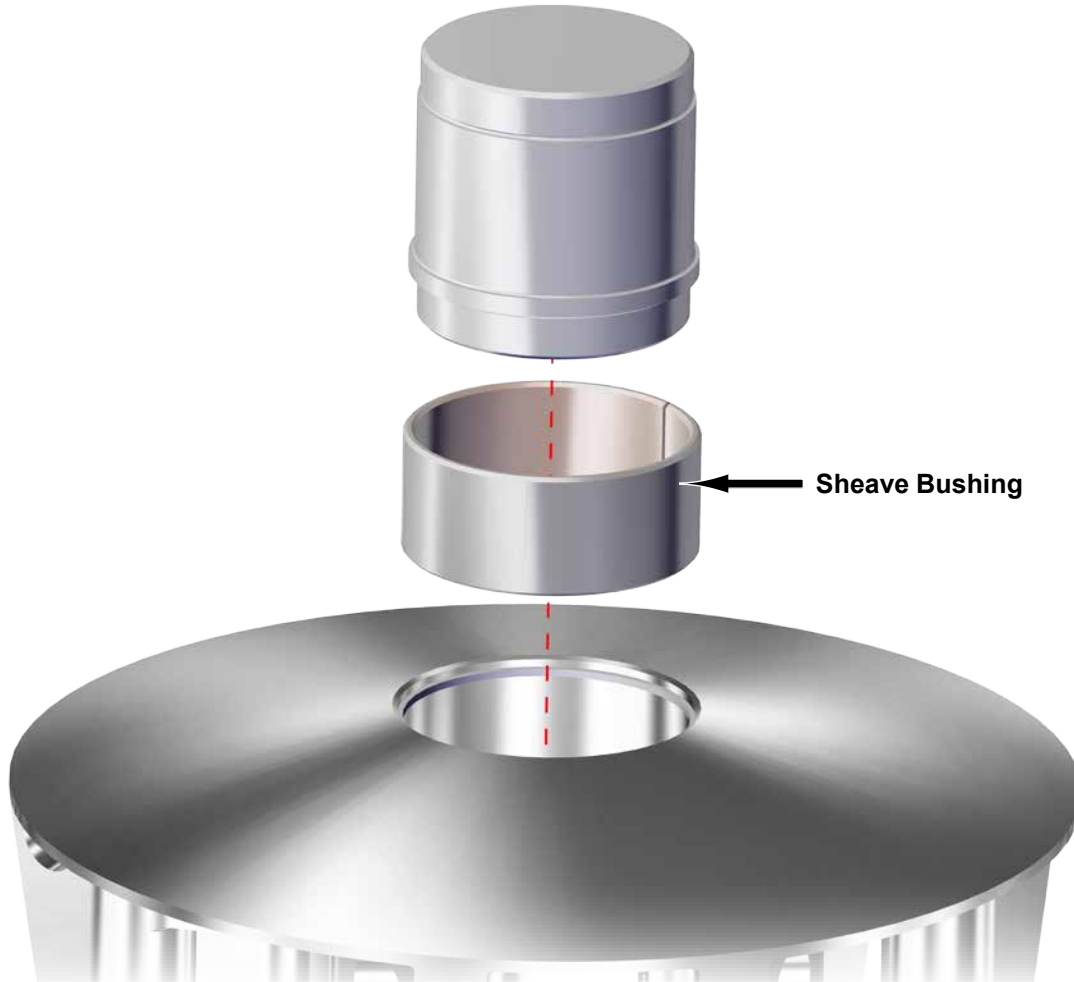
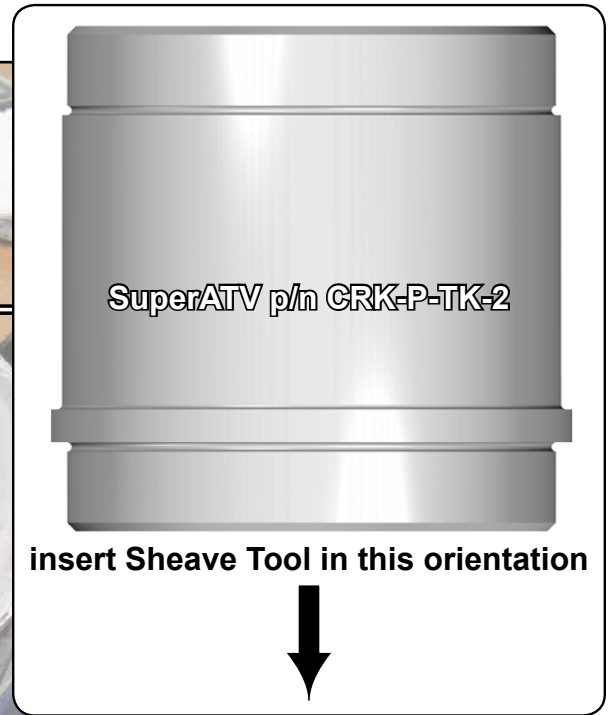

- Remove Snap Ring from Cover.



- Place Cover Tool into Cover and press out Bushing.

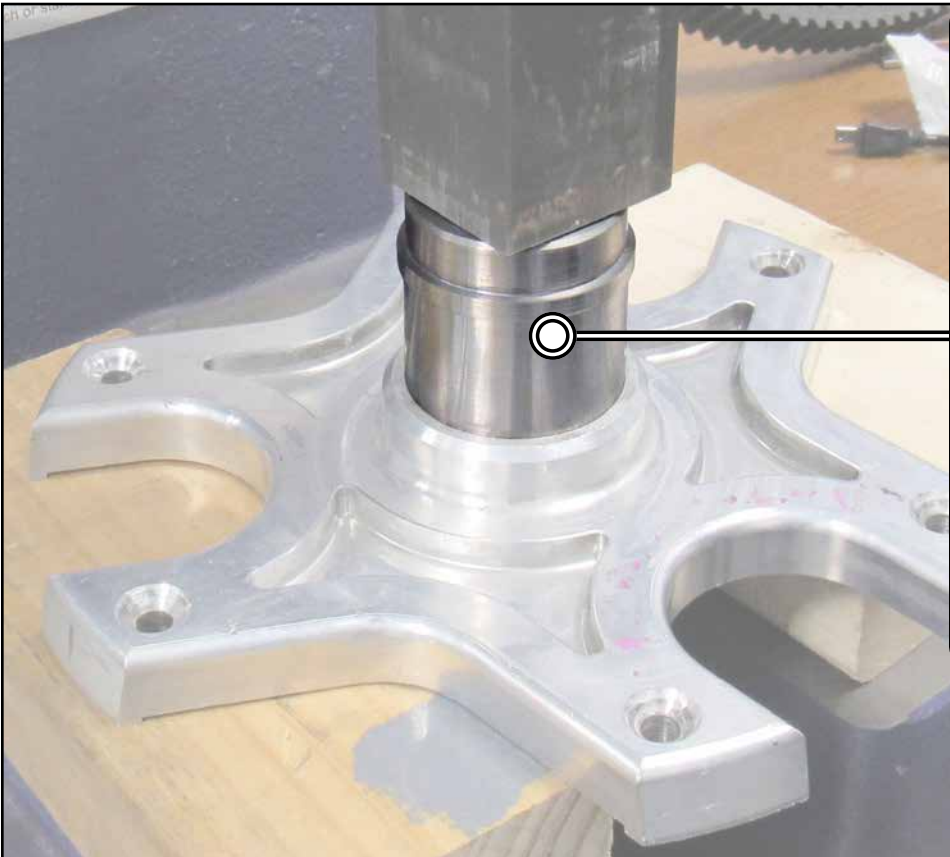

- Flip Cover, install new Bushing, and place Cover Tool as shown.
- Press Cover Bushing into place.

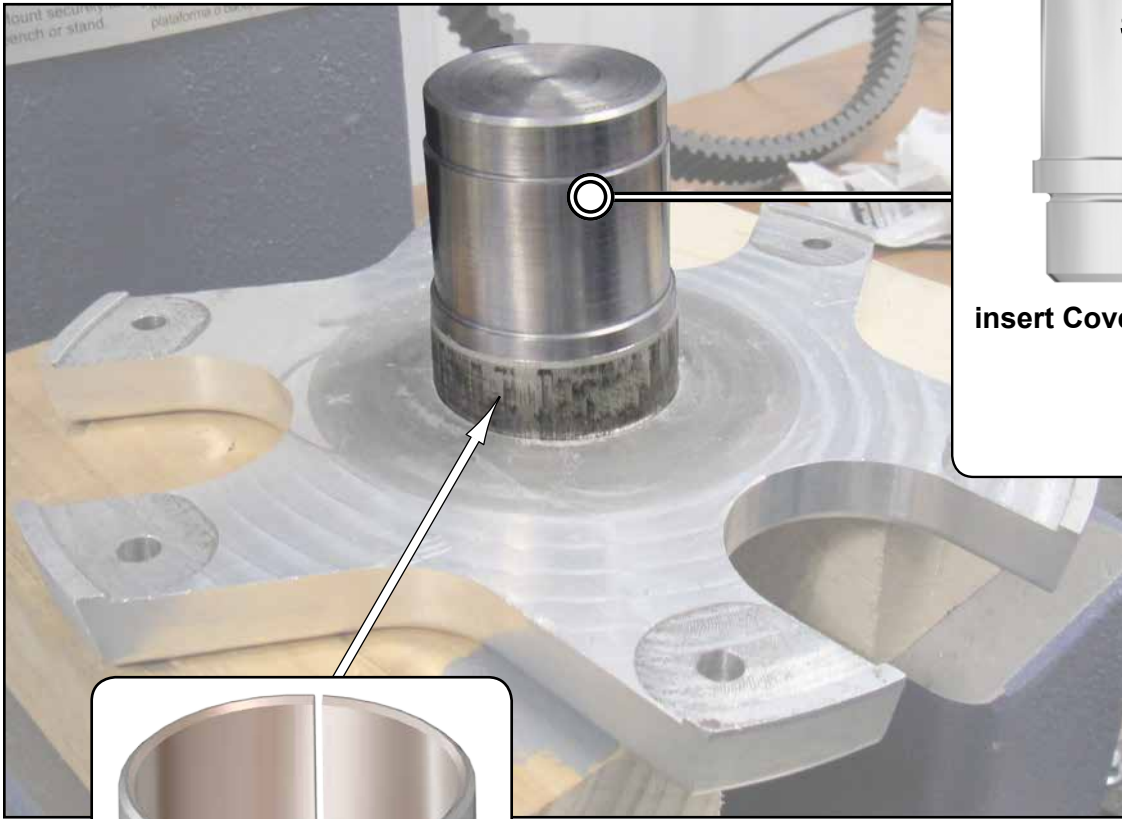

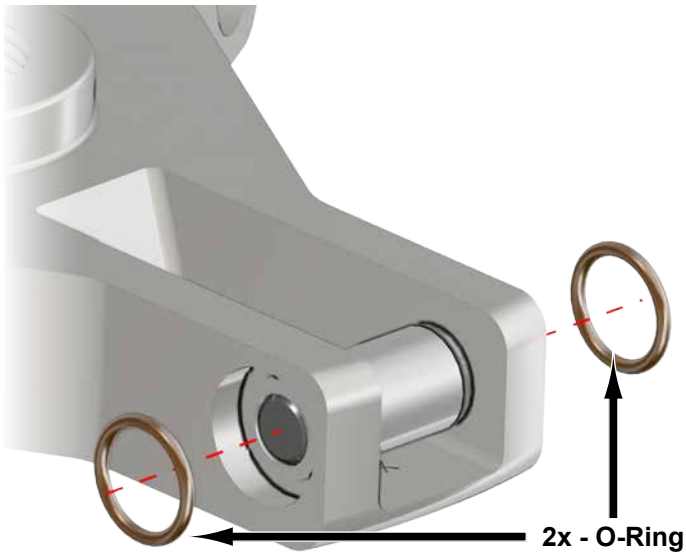

- Reinstall O-Rings and Buttons to Spider.
- To help keep components from falling out, slide Spider into place after each set of O-Rings and Bushings is installed.

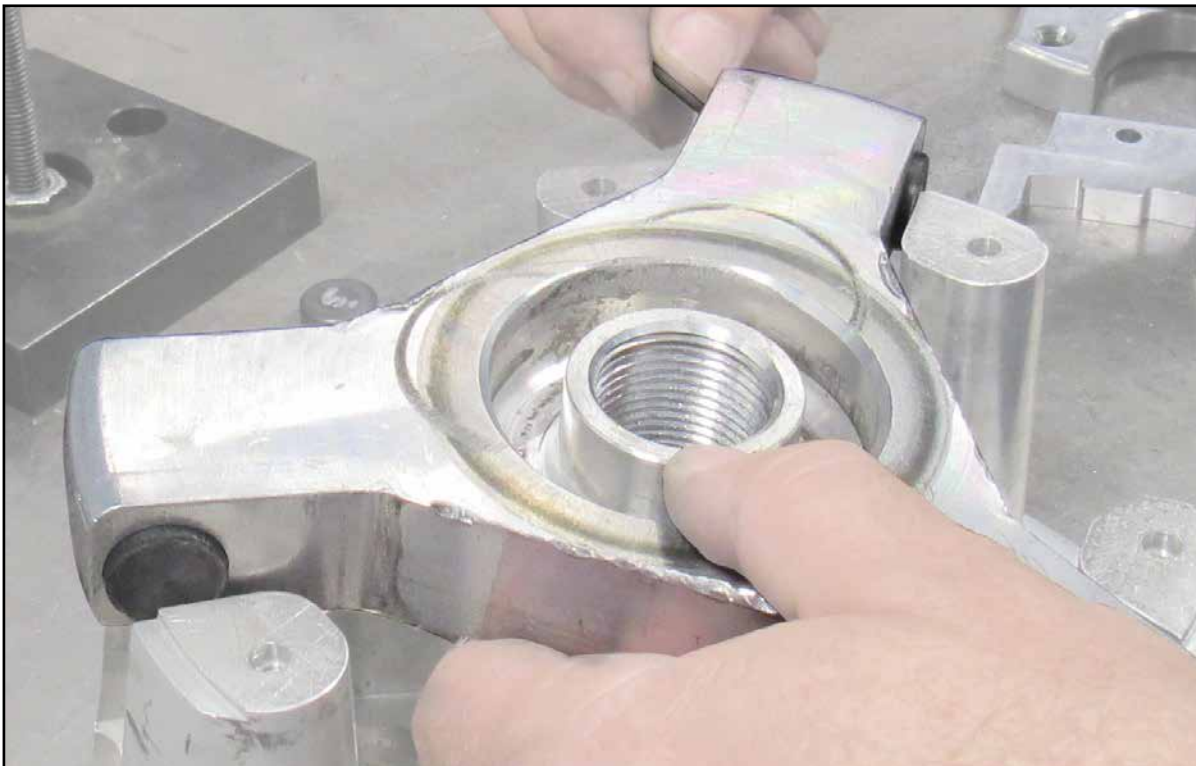
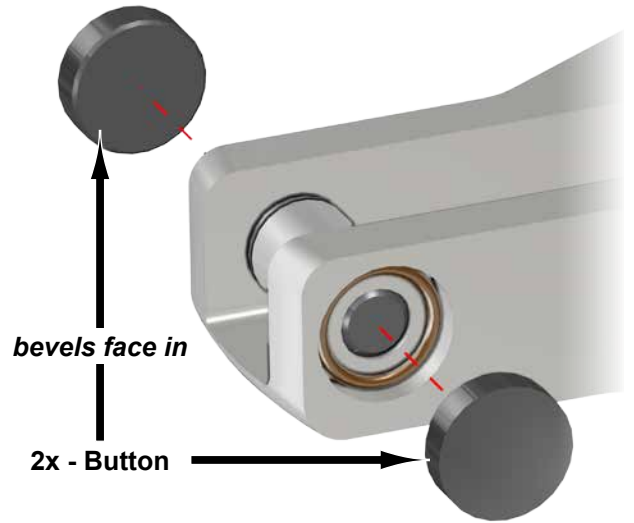

- Place Spider into Moveable Sheave and reverse removal steps to reassemble Clutch components.