

- Do not discard packaging until product has been successfully installed.
- SuperATV Carrier Bearing is required for Rear Shaft and Front - Rear Shafts combination SKU's.

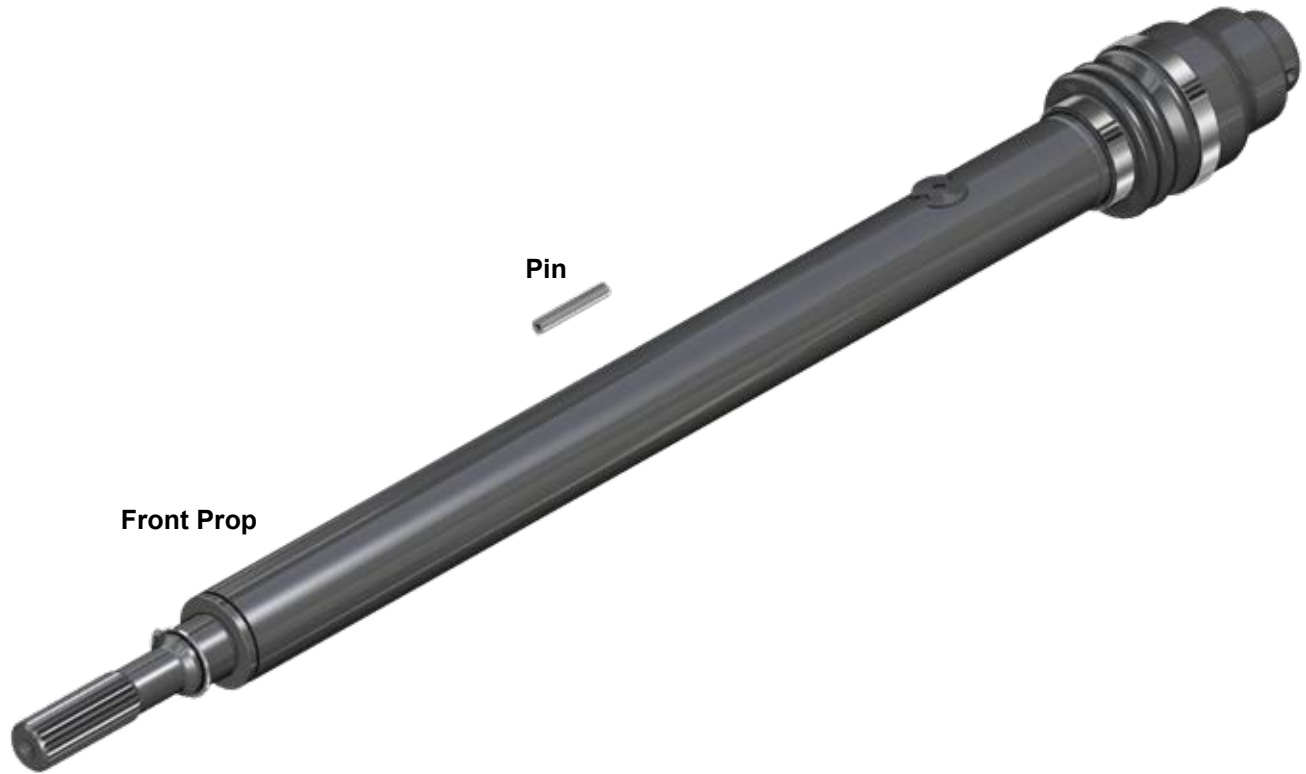

Installation instructions also cover Carrier Bearing SKU's:

BEA01-005  
BEA-P-013



**Need help with your installation?**



sales@superatv.com



www.superatv.com



1-855-743-3427



8:00am - 9:00pm EST M-Th  
8:00am - 7:00pm EST Friday  
9:00am - 2:00pm EST Saturday

**Read instructions and view illustrations before beginning.**

*Thank You  
For Choosing*







- If there is no Inner Support Bracket present, do not proceed with installation.
- Fully inspect your Gas Tank for damage that could have occurred from contact between the Gas Tank and Prop Shaft before proceeding. If there is cracking or signs of wear, please replace your Gas Tank.
- Contact your preferred Polaris dealer to purchase OEM Inner Support Bracket and/or Gas Tank if needed.
- Contact SuperATV Customer Support if there are questions.

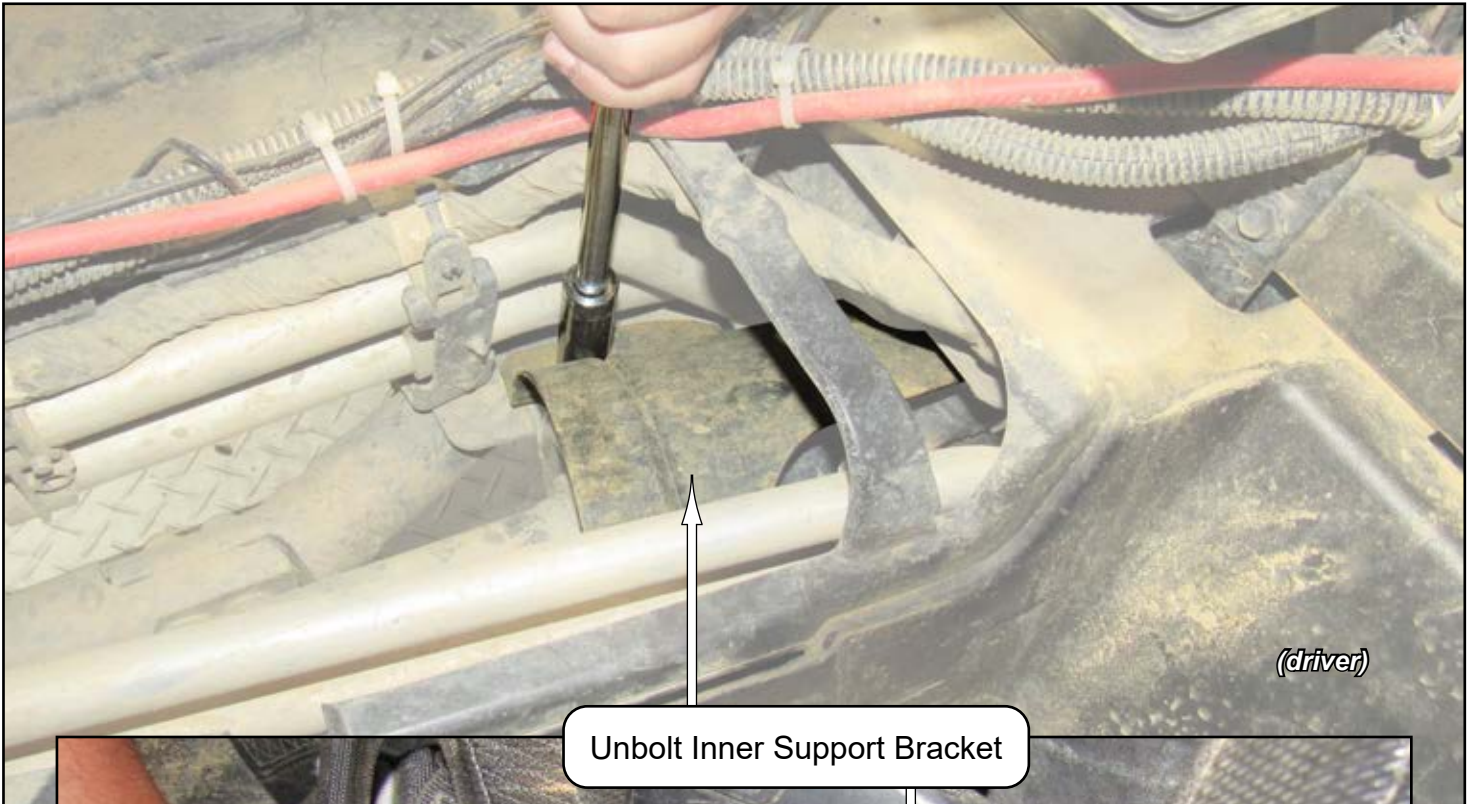

Unbolt Inner Support Bracket





*(driver)*

**Unbolt Motor Mount.**



**Space Motor Mount away from Frame.**



Remove Rear Shaft; pull out from rear of machine.

*(driver)*



*(driver)*

Remove Inner Support Bracket and hardware from stock Bearing Carrier.

- Align holes in Inner Support Bracket with slots in Carrier Bearing. Minor bending of Inner Support Bracket will be required.
- Ensure that Zerk Fitting, in Carrier Bearing, is facing forwards or backwards.

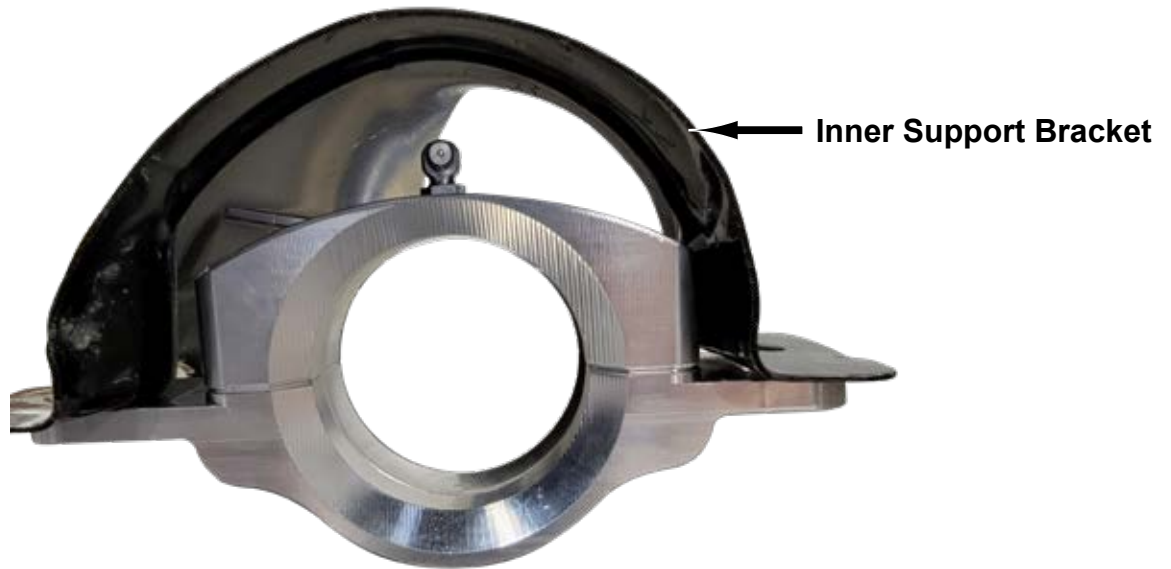

**Machines with SuperATV Remote Grease Line installed:**

- Ø11/16" Hole must be drilled into Inner Support Bracket in approximate location shown.



**Turbo S models will require additional modifications. See next page.**

**Set Inner Support Bracket aside.**

## Turbo S models only

- After adjusting Inner Support Bracket, holes in Carrier Bearing and Inner Support Bracket will not line up.
- Mark where material will need to be removed on Inner Support Bracket.
- Remove material and recheck hole alignment.

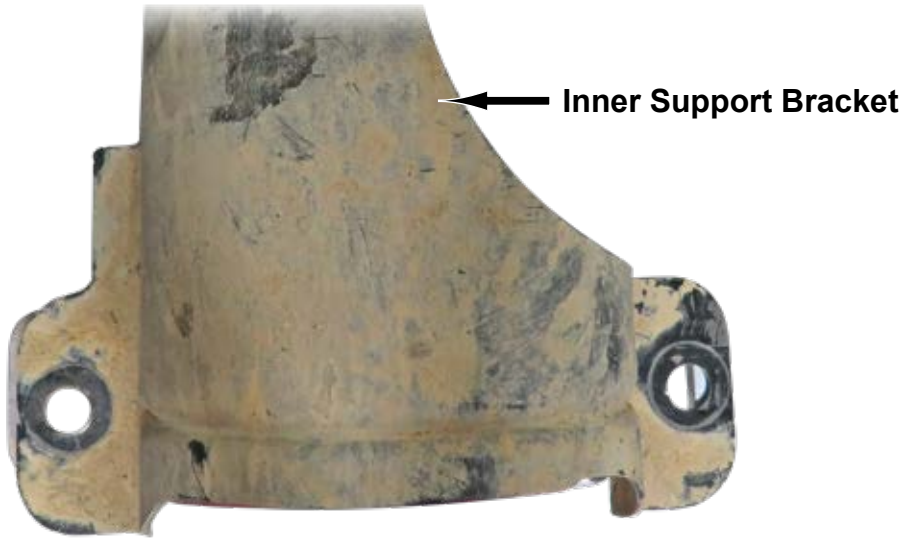



- Completely clean off all oil, grease, or dirt on Front Shaft in highlighted area.
- Apply supplied green retaining compound to Shaft.
- Install new Bearing and reinstall previously removed Clip.

**Must cure 24 hours before next step.**

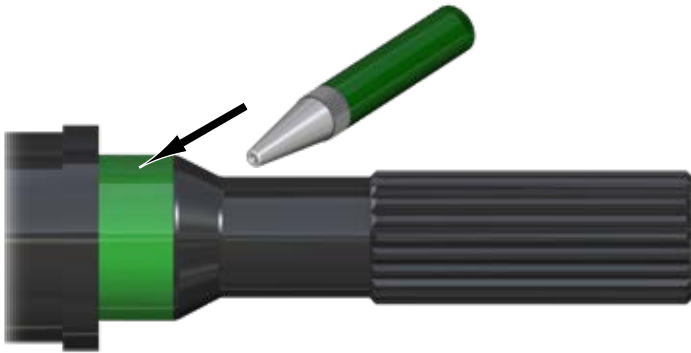

- Completely clean oil from seating area of Carrier Bearing.

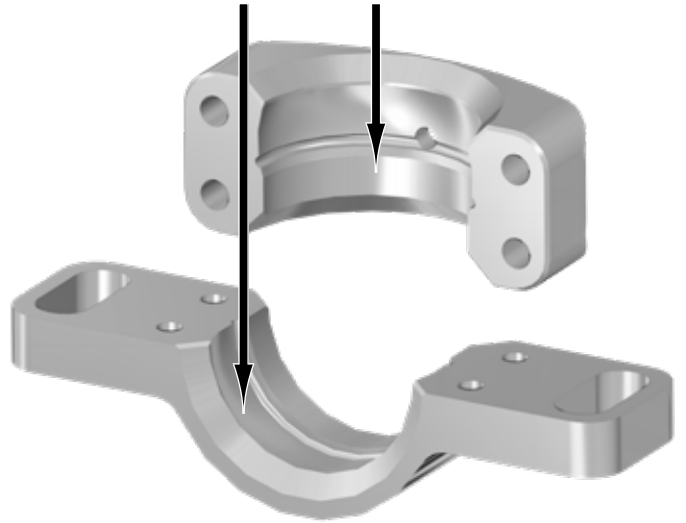

- Grease Ring to always face center of Carrier Bearing.
- Grease Ring to be in-line with Top and Bottom pieces.



Remove Clip from Front Prop and install Bearing. Reinstall Clip.

*\*Stock Front Prop will not have a Clip to remove or reinstall.*



**STOP** See page 11 for correct alignment illustrations.

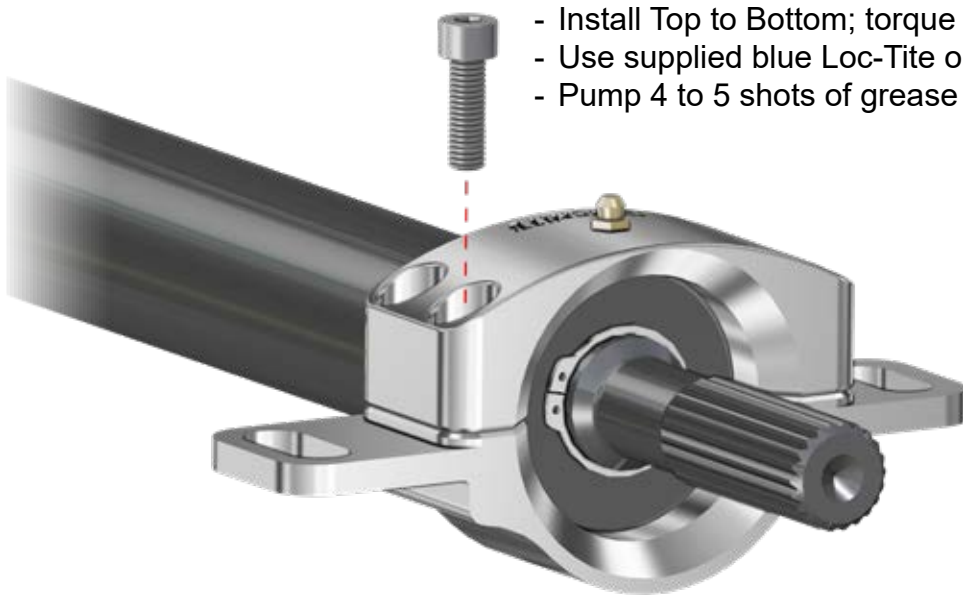

- Install Top to Bottom; torque Bolts to 20 ft/lbs.
- Use supplied blue Loc-Tite on bolts.
- Pump 4 to 5 shots of grease into Carrier Bearing.

- Temporarily secure Carrier Bearing with stock hardware to verify proper alignment of Front Prop; do not tighten.
- Remove hardware and reinstall previously removed, and modified, Inner Support Bracket.
- Reinstall Carrier Bearing bolts with properly installed Inner Support Bracket; torque to 45 ft/lbs.



- If reusing existing Rear Prop Shaft, reinstall using same method shown for removal.
- If installing SuperATV Rear Prop Shaft, proceed to “Rear Prop Shaft” installation instructions.

### **“Positioning”**

- Depending on model, Bottom may need to be moved forward or rearward.
- Dimension “A” **must always be equal** regardless of where Bottom is positioned.

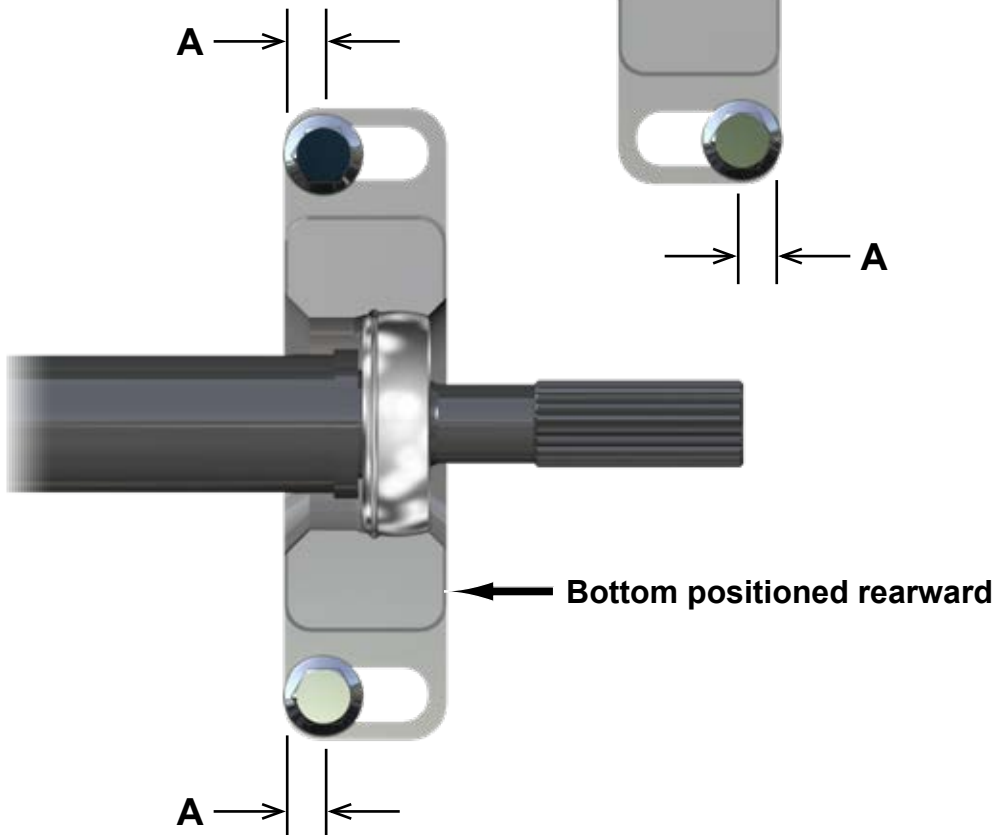
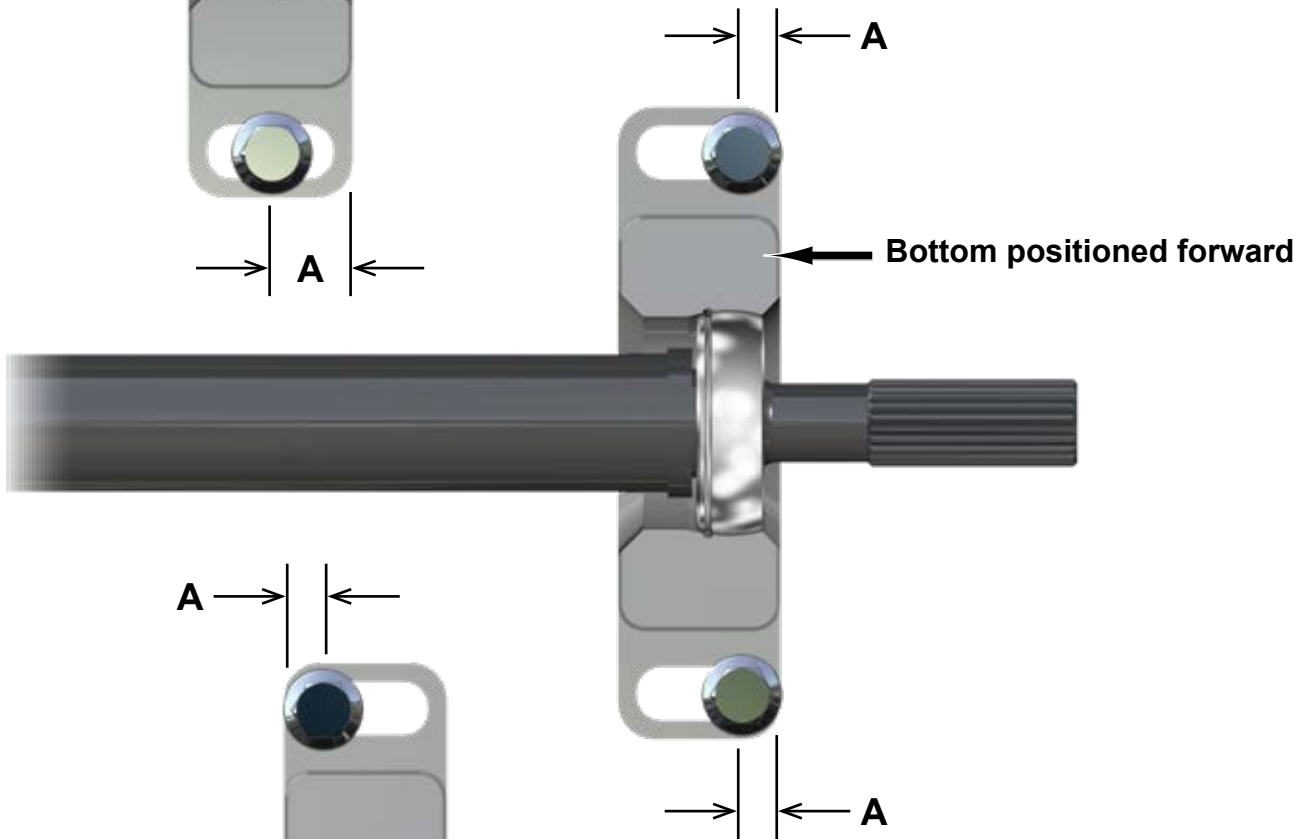
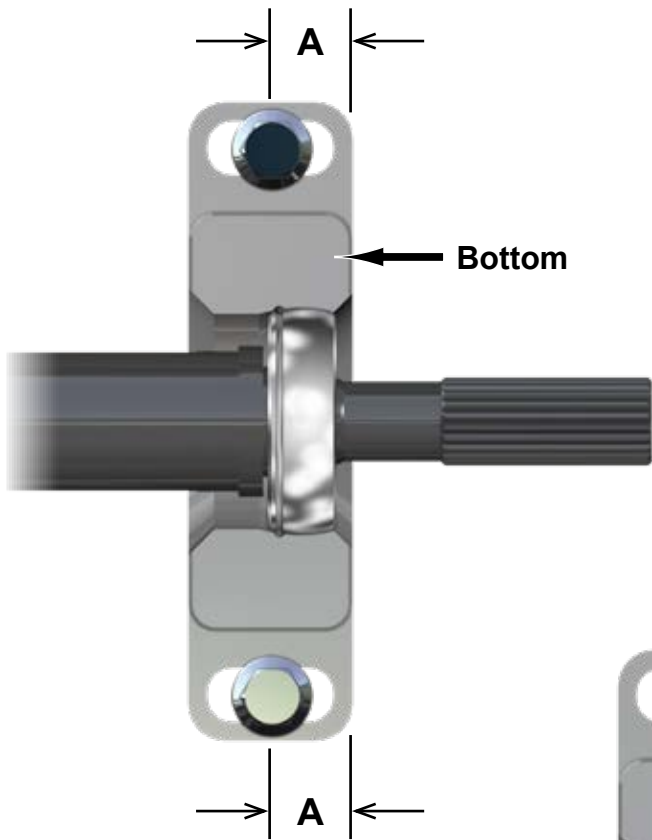

“Rear Prop Shaft” installation:

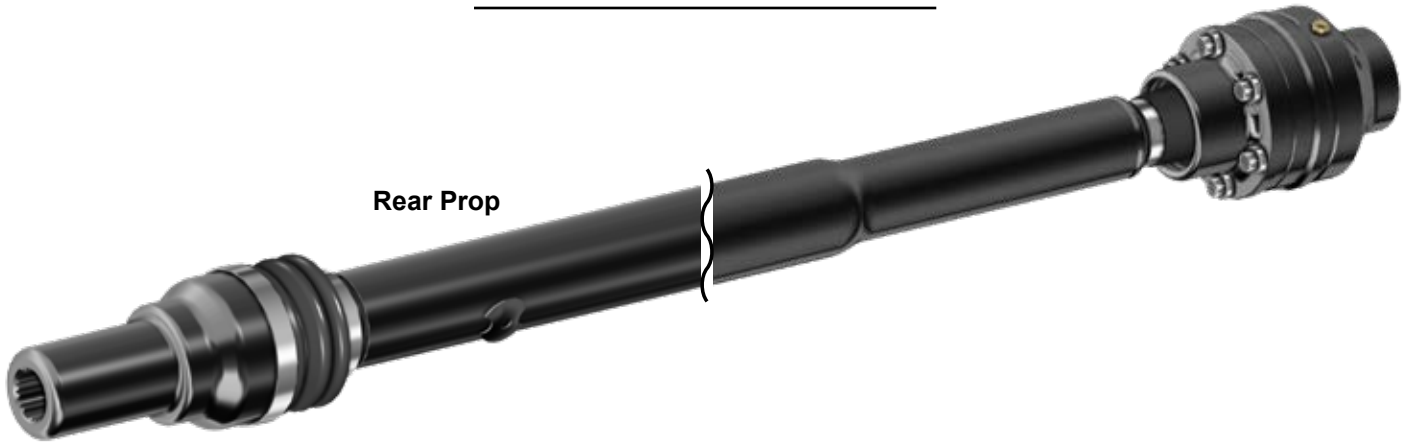

Rear Prop



separate Prop Flange from Rear Prop

**“Rear Prop Shaft” installation continued:**

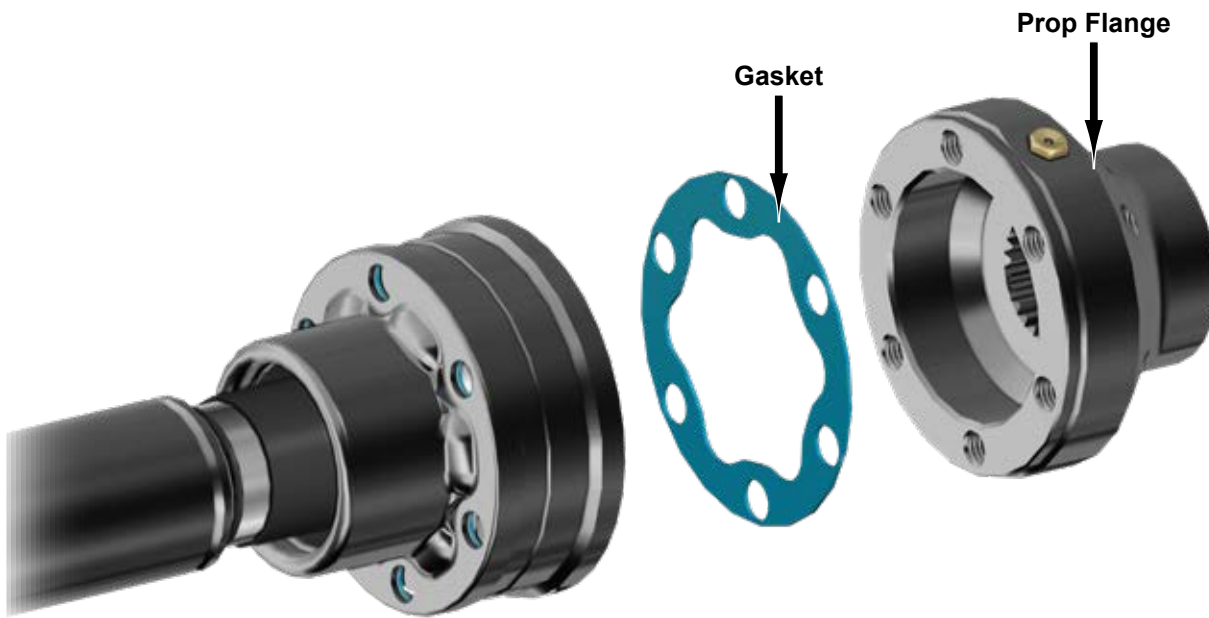

**secure Prop Flange to Output Shaft  
with stock Nut and Washer**



**secure Prop Shaft and Gasket to Prop Flange**

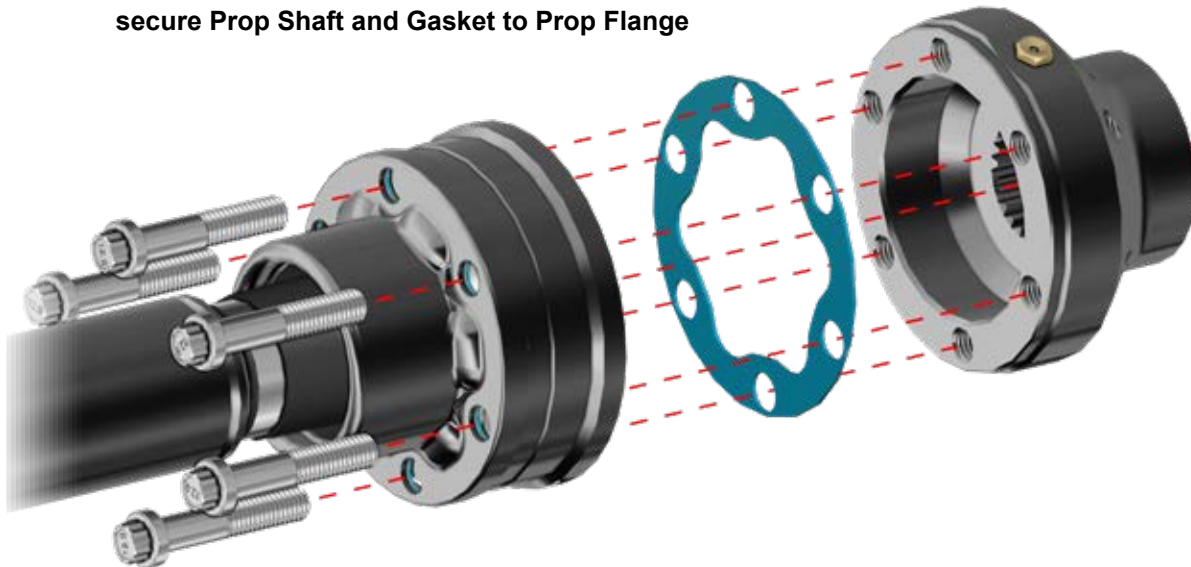

**Liability Statement**

SuperATV's® products are designed to best fit user's ATV/UTV under stock conditions. Adding, modifying, or fabricating any factory or aftermarket parts will void any warranty provided by SuperATV® and is not recommended. SuperATV's® products could interfere with other aftermarket accessories. If user has aftermarket products on machine, contact SuperATV® to verify that they will work together.

Although SuperATV® has thousands of satisfied customers, user should be aware that installing lift kits, long travel, or suspension kits, tires, etc. will change the ride of machine and may increase maintenance and part wear. Operating any off-road machine while, or after, consuming alcohol and/or drugs increases risk of bodily harm or death. No warranty or representation is made as to this product's ability to protect user from severe injury or death. SuperATV® urges operators and occupants to wear a helmet and appropriate riding gear at all times.

By purchasing and installing SuperATV® products, user agrees that should damages occur, SuperATV® will not be held responsible for loss of time, use, labor fees, replacement parts, or freight charges. SuperATV®, nor any 3rd party, will not be held responsible for any direct, indirect, incidental, special, or consequential damages that result from any product purchased from SuperATV®. The total liability of seller to user for all damages, losses, and causes of action, if any, shall not exceed the total purchase price paid for the product that gave rise to the claim.

SuperATV® will warranty only parts provided by SuperATV®. Any damage or problems with OEM housings, bearings, seals, or other manufacturers' products will not be covered by SuperATV®. SuperATV® parts and products are not warrantied if item was not installed properly, misused, or modified.

Installing, adding, modifying, or fabricating any factory or aftermarket product to your ATV/UTV may violate certain local, state, and federal laws. Be advised that laws vary depending on town, city, county, state, etc. Use of certain products on public streets, roads, or highways may be in violation law. The Buyer is solely and exclusively legally and personally responsible for any violation of the law by the installation or use of the product. You must abide by all local, state, and federal laws, including but not limited to vehicle safety, traffic laws, and ordinances. It is your responsibility to know the laws and how they apply to you.

The Buyer is responsible to fully understand the capability and limitations of his/her vehicle according to manufacturer specifications, warnings and instructions and agrees to hold SuperATV® harmless from any damage resulting from failure to adhere to such specifications, warnings and/ or instructions. The Buyer is also responsible to obey all applicable federal, state, and local laws and ordinances when operating his/her vehicle while using this product, and the Buyer agrees to hold SuperATV® harmless from any violation thereof.