



IMPORTANT WARRANTY & INSTALLATION  
INSTRUCTIONS ATTACHED

*Please Forward All Attached Information to Consumer  
Warranty Not Valid Unless Returned to CORSA Performance*

**We ask that you take a few moments to complete our warranty registration form:**

TO ACTIVATE YOUR LIMITED LIFETIME WARRANTY GO TO:  
**[CORSAPERFORMANCE.COM/WARRANTY](http://CORSAPERFORMANCE.COM/WARRANTY)**



**For Full-Color Installation Instructions, Please Visit:  
[CORSAPERFORMANCE.COM](http://CORSAPERFORMANCE.COM) and Search by Part Number**

Please be sure to review the enclosed instructions prior to beginning the installation process. If you have any questions about the enclosed parts, instructions or encounter a problem during installation:  
**CALL CORSA PERFORMANCE TECHNICAL ASSISTANCE AT 800.486.0999**

Please take time to read and understand these installation instructions.

CORSA recommends that the installation of this system be performed by a qualified service center or professional muffler installer who has the necessary equipment, tools and experienced personnel. However, if you decide to perform this install, the use of a hoist and an additional person will be required.

**CAUTION:** Never work on a hot exhaust system. Allow time for the vehicle to cool. Always wear eye protection when working under a vehicle.

### Recommended Tools:

- 3/8" drive ratchet
- 3/8" drive 10mm socket
- 3/8" drive 15mm deep socket
- 10" 3/8" ratchet extension
- Grommet pullers
- Soap and water solution
- Torque Wrench
- Penetrating lubricant spray
- Safety glasses

**Please confirm that all parts are present according to the bill of materials before beginning the installation.**

If something is missing call Tech Support at 1- 800-486-0999

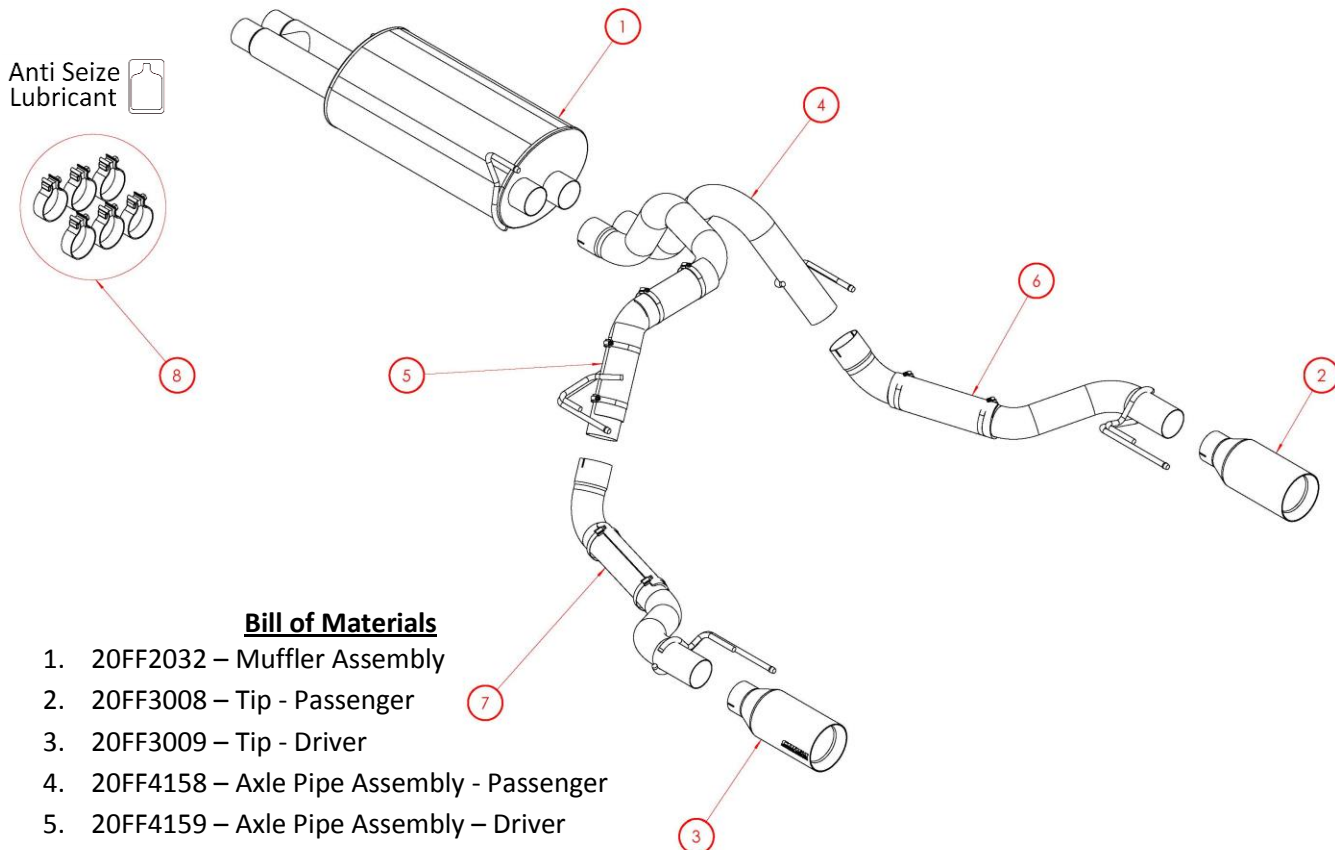

### Bill of Materials

1. 20FF2032 – Muffler Assembly
2. 20FF3008 – Tip - Passenger
3. 20FF3009 – Tip - Driver
4. 20FF4158 – Axle Pipe Assembly - Passenger
5. 20FF4159 – Axle Pipe Assembly – Driver
6. 20FF4160 – Tailpipe Assembly – Passenger
7. 20FF4161 – Tailpipe Assembly – Driver
8. 15AT7007 – Hardware Kit

### Factory Exhaust System Removal:

1. Using a 15mm deep socket and 3/8" drive ratchet, loosen the two clamps on the axle pipes located just over the rear axle downstream of the rear muffler. **(Fig. A)** Using a screw driver pry open the spring clip holding the locating pin on the driver and passenger side tailpipes. **(Fig. B)**
2. Using a 10mm socket, 3/8" drive ratchet, and a long extension, loosen and remove the driver and passenger side axle pipe hanger assemblies. **(Fig. C)**
3. Using a 10mm socket and 3/8" drive ratchet loosen and remove the two nuts and studs holding the tailpipe hanger assembly located to the inside of the driver and passenger side exhaust tips. **(Fig. D)** The tailpipes will no longer be supported. Slightly lower the passenger side tailpipe assembly and remove rearwards. Next, slide the driver side tailpipe assembly rearwards to free it from the connection point and maneuver the tailpipe from over the axle and around the spare tire. **(Fig. E)**
4. Loosen the clamp and sleeve clamp connection located after the stock resonator using a 15mm deep socket and ratchet. The stock clamp is welded to the resonator assembly and cannot be removed or rotated. **(Fig. F)**
5. Using a 10mm socket and 3/8" drive ratchet loosen and remove the two bolts holding the front muffler hanger. **(Fig. G)** Next, loosen and remove the bolt holding up the rear muffler hanger assembly. **(Fig. H)** The rear muffler will no longer be supported; remove by sliding it rearwards to free the muffler inlet pipes from the connection point. **(Fig. I)**
6. Remove the stock sleeve clamp from the muffler inlet pipe by prying open the spring clip with a flat head screw driver and sliding the clamp off the pipe. **(Fig. J)** Place the stock sleeve clamp in a safe location as it will be reused during the installation of your new CORSA Performance Exhaust System.
7. Removal all of the hanger grommet assemblies from their corresponding hangers and store them in a safe location as they will be reused during the installation of your CORSA Performance Exhaust System. **(Fig. K)**

**NOTE:** The use of a soap and water solution may aid in the removal of hanger grommets.

**REMOVAL PICTURES ON NEXT PAGE** 

## Factory Exhaust Removal Pictures



Fig. A



Fig. B



Fig. C



Fig. D



Fig. E

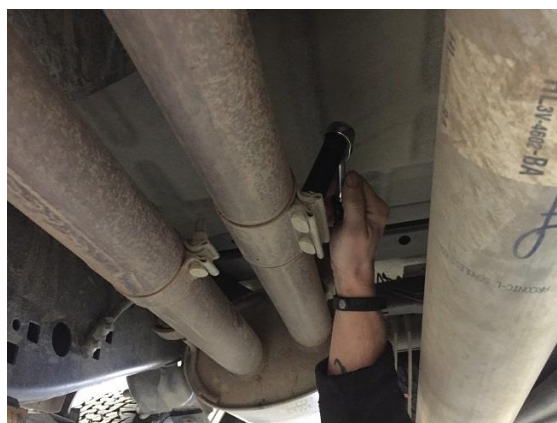

Fig. F

**CONTINUED ON NEXT PAGE** 

### Factory Exhaust Removal Pictures



Fig. G



Fig. H

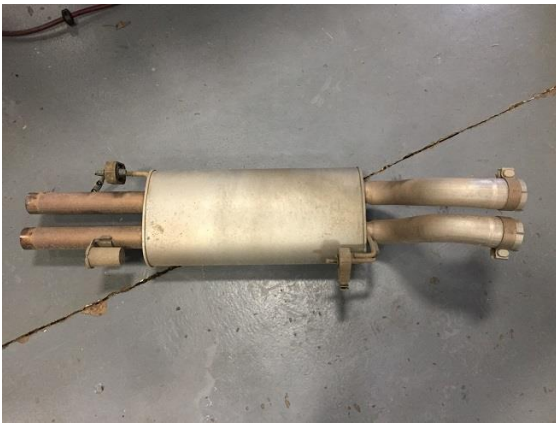

Fig. I



Fig. J

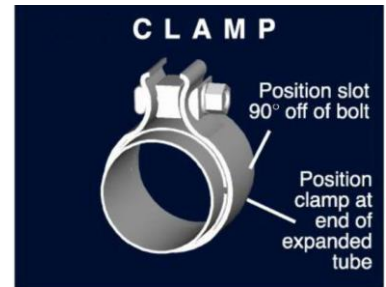

Fig. K

## Installation of CORSA Exhaust System:

**NOTE:** Apply the anti-seize lubricant (*supplied*) to the threads **ONLY** of all the clamps and flange bolts. Failure to follow this procedure can cause nuts to seize on clamps and potentially destroy threads. After applying anti-seize lubricant, be sure to thoroughly clean your hands, as lubricant will tarnish stainless steel. All clamps should be tightened using a properly calibrated Torque Wrench. Using an air impact gun will damage the clamp and reduce its ability to effectively seal the joint. It may also cause the joint to separate, thereby causing damage to your exhaust system and to your vehicle.

**NOTE:** Align all clamps so that the center of the clamp bolt is 90 degrees from the notch in the pipe. (See Fig. CLAMP)



**NOTE: IN ORDER TO ACHIEVE AND CONFIRM PROPER CLEARANCES BETWEEN THE EXHAUST SYSTEM ROUTING AND THE REAR SUSPENSION, THIS KIT MUST BE INSTALLED ON A TWO POST LIFT OR WITH THE REAR SUSPENSION FULLY DECOMPRESSED.**

1. Remove all exhaust components from the shipping carton, including all clamps and hardware.
  2. Locate the stock sleeve clamp removed from step #6 of the stock exhaust removal instructions. Install the sleeve clamp on the driver stock resonator or CORSA X-Pipe outlet pipe so that the bolts are vertical, with the nuts towards the ground and the bolts are towards the center of the vehicle. **(Fig. L)**
  3. Locate the CORSA performance muffler and stock front muffler hanger and the rear muffler hanger grommet assembly removed during step #7 of the stock exhaust removal instructions. Install the stock front hanger assembly onto the CORSA muffler in the same orientation as it was on the stock muffler. Install the stock rear muffler hanger grommet assembly onto the rear hanger of the CORSA muffler in the same orientation as stock.
- NOTE:** The use of a soap and water solution may aid in the installation of hanger grommets.
4. Slide the passenger rear muffler inlet pipe into the expanded end of the resonator outlet pipe and the driver side into the sleeve clamp. Next, install the rear muffler hanger grommet assembly and bolt it down using a 10mm socket and 3/8" drive ratchet. **(Fig. M)** Install the front muffler hanger to the vehicle frame using the 10mm socket and 3/8" drive ratchet. **(Fig. N)** Snug the sleeve clamp using a 15mm deep socket and 3/8" drive ratchet followed by the clamp. **(Fig. O)**

CONTINUED ON NEXT PAGE 

5. Locate the passenger side axle pipe assembly along with a 3" clamp and the corresponding stock axle pipe hanger grommet assembly. Install the hanger grommet assembly onto the axle pipe hanger in the same orientation as it was removed from the stock axle pipe hanger. **(Fig. P)** Next, slide the expanded end of the axle pipe over the passenger side muffler outlet pipe. **(Fig. Q)** Bolt the hanger grommet assembly to the vehicle chassis using a 10mm socket and ratchet. **(Fig. R)** Lastly, position the 3" clamp so that the bolt is vertical with the nut towards the ground and the bolt towards the outside of the vehicle. Snug the clamp using a 15mm deep socket and ratchet.
6. Locate the driver side axle pipe assembly along with a 3" clamp and the corresponding stock axle pipe hanger grommet assembly. Install the hanger grommet assembly onto the axle pipe hanger in the same orientation as it was removed from the stock axle pipe hanger. **(Fig. S)** Snake the axle pipe around the rear tire and over the rear differential and slide the expanded end of the axle pipe over the driver side muffler outlet pipe. Bolt the hanger grommet assembly to the vehicle chassis using a 10mm socket and ratchet. Finally, position the 3" clamp so that the bolt is vertical with the nut towards the ground and the bolt towards the center of the vehicle. Snug the clamp using a 15mm deep socket and ratchet. **(Fig. T)**
7. Locate the driver side tailpipe assembly, a 3" clamp, and the corresponding tailpipe grommet assembly and hardware. Install the grommet assembly on the tailpipe hanger in the same position as stock. **(Fig. U)** Install the 3" clamp on the expanded end of the tailpipe. Position the clamp so that the bolt is parallel with the ground and the nut is facing towards the rear of the vehicle with the bolt over the pipe. Slide the expanded outlet end of the tailpipe onto the driver axle pipe outlet. **(Fig. V)** Next, slide the hanger grommet against the vehicle chassis, insert the threaded stud assembly from the rear of the vehicle and install the two nuts using a 10mm socket and 3/8" ratchet. **(Fig. W & X)** Snug the clamp using a 15mm deep socket and ratchet. **(Fig. Y)**
8. Locate the passenger side tailpipe assembly, a 3" clamp, and the corresponding tailpipe grommet assembly and hardware. Install the grommet assembly on the tailpipe hanger in the same position as stock. Install the 3" clamp on the expanded end of the tailpipe. Position the clamp so that the bolt is parallel with the ground and the nut is facing towards the rear of the vehicle with the bolt over the pipe. Next, slide the hanger grommet against the vehicle chassis, insert the threaded stud assembly from the rear of the vehicle and install the two nuts using a 10mm socket and 3/8" driver ratchet.
9. Locate the passenger side tip and one 3" clamp. Install the clamp on the tip inlet so that the bolt is parallel with the ground and the nut is towards the inside of the vehicle and bolt is located over the pipe. Slide the tip over the tailpipe outlet and position the etch on the side of the tip. **(Fig. Z)** Snug the clamp using a 15mm deep socket and ratchet.

**NOTE:** The rear tailpipe hanger has plenty of adjustment. Ideally the bottom lip of the hanger grommet should be parallel and level with the vehicle chassis. Loosening and adjusting the position of the hanger grommet will result in lateral and vertical tip adjustment.

**CONTINUE ON NEXT PAGE** 

10. Repeat the previous step for the driver side of the vehicle.
11. Visually inspect the exhaust system position, tip alignment, clamp orientation and position, and exhaust pipe clearance. Make any necessary adjustments at the slip joints. Inspect the heat shields on the driver side axle pipe, and passenger and driver side tailpipe assemblies. The heat shields should be positioned towards the spare tire and the clamps should not be torque to more than 35 in.-lbs. Re-align the heat shields as necessary. Check clearances between the spare tire and rear leaf spring suspension on both driver and passenger sides. **(Fig. AA)**
12. Starting at the front of the vehicle and working towards the rear, torque all the clamps to 45 ft-lbs.
13. It is **STRONGLY SUGGESTED** that all clamps be checked and re-tightened (if necessary) to the recommended torque after initial road testing of the vehicle, as thermal cycling has occurred on the system. Please wait until the system has fully cooled to perform this step.

**NOTE:** During cold weather start-ups, you may experience an exhaust sound that is deeper and louder in tone than usual. This is temporary and will diminish to normal levels once your engine has reached its normal operating temperature.

**NOTE:** Immediately following the installation of your exhaust system, you may experience a trace of smoke after initial start-up. **DO NOT** be alarmed. The smoke is caused by the burning of a small amount of forming oil residue used in the manufacturing process.

**INSTALLATION PICTURES ON NEXT PAGE** 



## CORSA Exhaust Installation Pictures



Fig. L



Fig. M



Fig. N

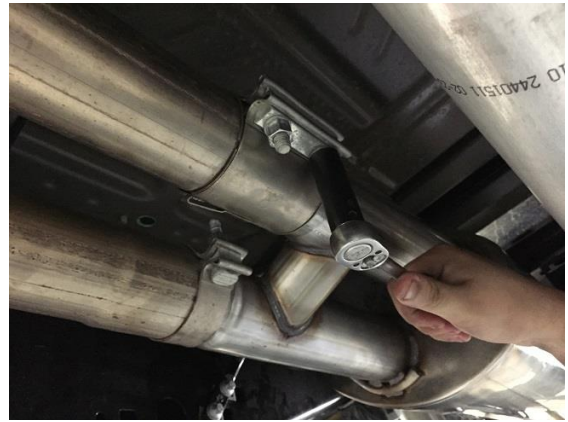

Fig. O



Fig. P

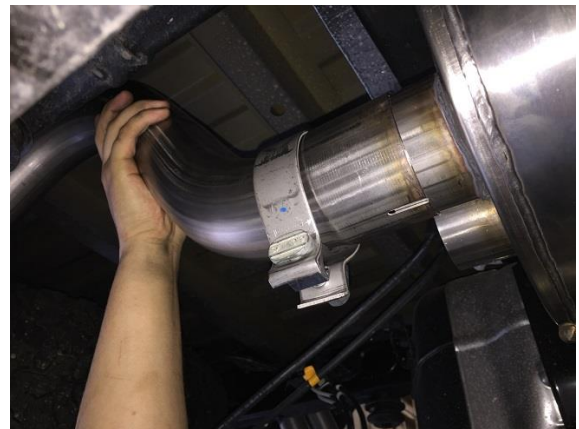

Fig. Q

**CONTINUED ON NEXT PAGE** 

## CORSA Exhaust Installation Pictures:



Fig. R



Fig. S

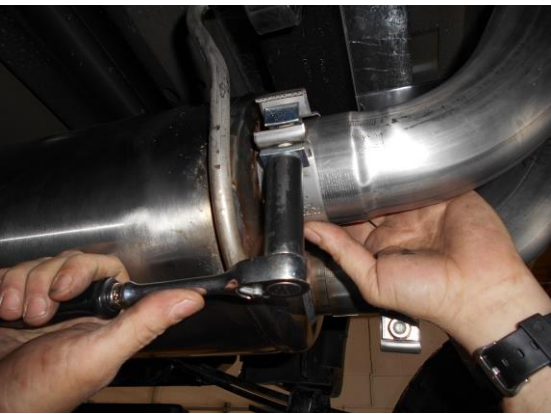

Fig. T



Fig. U

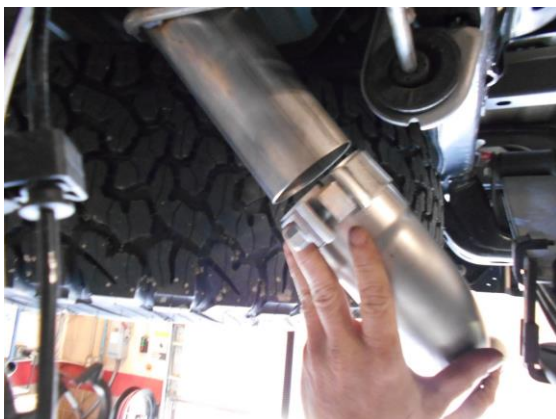

Fig. V

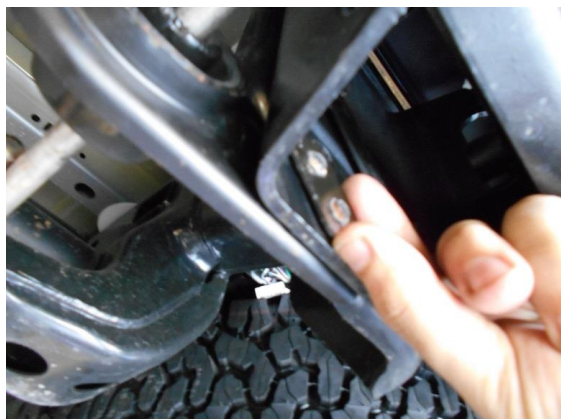

Fig. W

CONTINUED ON NEXT PAGE 

### CORSA Exhaust Installation Pictures:



Fig. X



Fig. Y



Fig. Z



Fig. AA



Fig. BB